



GOLD AND COMPANY, LLC

COMMERCIAL REAL ESTATE IN THE BALTIMORE METROPOLITAN AREA

INDUSTRIAL SITE FOR SALE



- **11.13 Acres**
- **Near BWI Corridor**
- **W-2 Zoning**
- **Secure Lot**
- **Ideal for Fleet Parking & Outdoor Storage**
- **Anne Arundel County - Near 695 and Baltimore Port**
- **Fenced, Paved, and Lit**
- **Contact Us For More Information**

7601 ENERGY PARKWAY, BALTIMORE, MD 21226

JIM CHIVERS - JIM@GOLDCOMMERCIAL.NET - 443.928.7522

JOHN ROE - JOHN@GOLDCOMMERCIAL.NET - 410.960.9554

This Property offering is subject to change without notice. All information is deemed reliable but not guaranteed



GOLD AND COMPANY, LLC

COMMERCIAL REAL ESTATE IN THE BALTIMORE METROPOLITAN AREA

PROPERTY SURVEY

7601 ENERGY PARKWAY, BALTIMORE, MD 21226

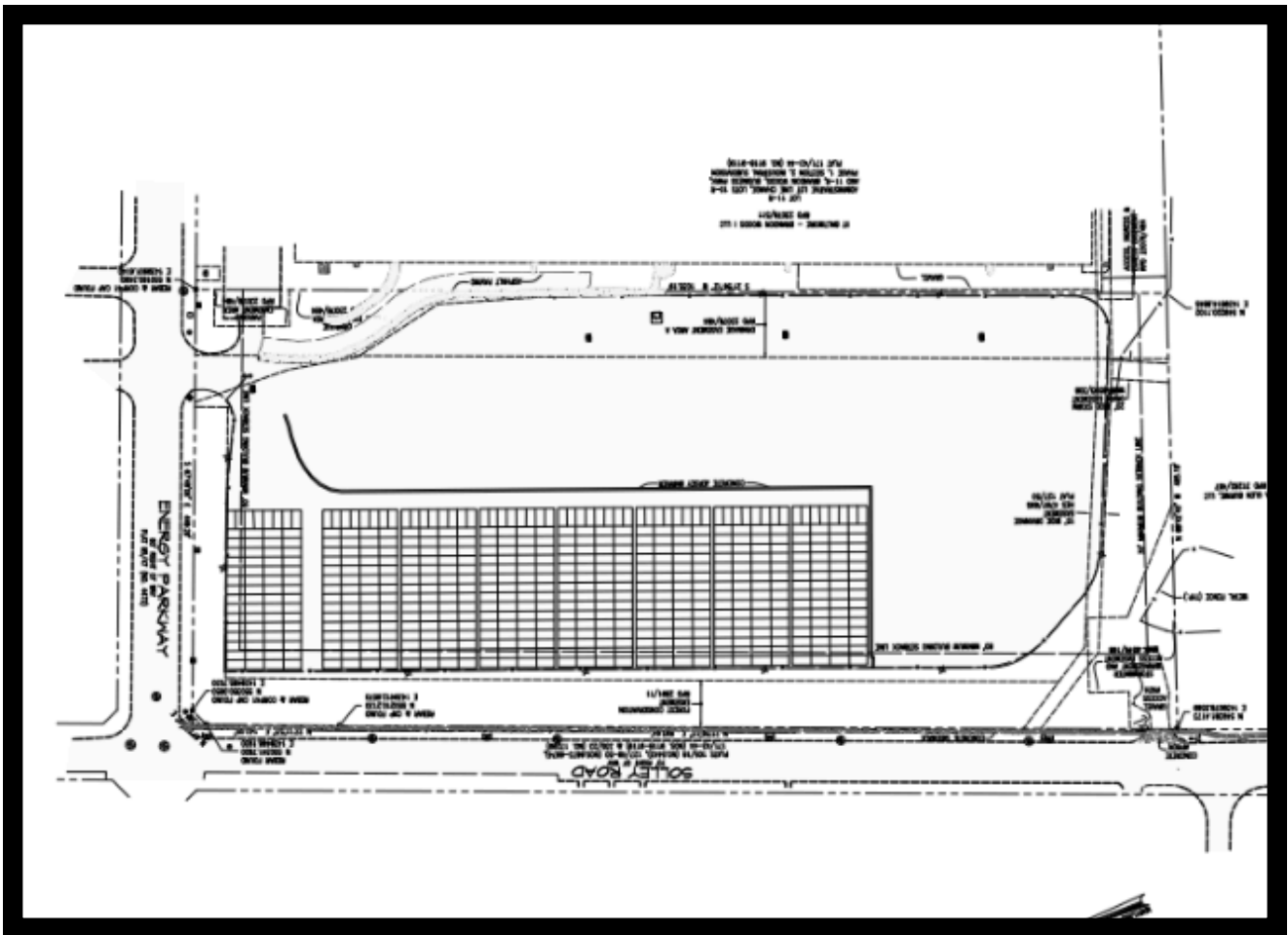

JIM CHIVERS - JIM@GOLDCOMMERCIAL.NET - 443.928.7522

JOHN ROE - JOHN@GOLDCOMMERCIAL.NET - 410.960.9554



GOLD AND COMPANY, LLC

COMMERCIAL REAL ESTATE IN THE BALTIMORE METROPOLITAN AREA

CONTACT

**Gold and Company, LLC
5601 Newbury St.
Baltimore, MD 21209**

Jim Chivers

**Sr. Vice President - 443.928.7522 cell
jim@goldcommercial.net**

John Roe

**Vice President - 410.960.9554 cell
john@goldcommercial.net**

WWW.GOLDCOMMERCIAL.NET