



GOLD AND COMPANY, LLC



3332-3360 Greenmount Avenue, Baltimore, MD 21218

Gold and Company, LLC

**5601 Newbury St.
Baltimore, MD 21209**

**Alex Simone
443.845.4413
Alex@goldcommercial.net**

**Mitch Gold
410.456.2492
Mitch@goldcommercial.net**

**Office: 410.578.1300
www.goldcommercial.net**

- **1,100-5,900 sf +/- retail-office available FOR LEASE**
- **Across 3 properties**
- **Greenmount Ave + E. 34th St**
- **C-1 zoning**
 - **Neighborhood Businesses**
- **Rear Parking Lot**
- **HUB Zone**
- **Enterprise Zone**
- **Major renovations planned**
- **Get in on the action**



Est. 1999

Gold and Company

Commercial Real Estate in the Baltimore Metropolitan Area

3332-3360 Greenmount Avenue, Baltimore, MD 21218



Alex Simone / Mitch Gold
Gold and Company, LLC
5601 Newbury St.
Baltimore, MD 21209

410.578.1300
www.goldcommercial.net



Gold and Company

Commercial Real Estate in the Baltimore Metropolitan Area

3332-3360 Greenmount Avenue, Baltimore, MD 21218

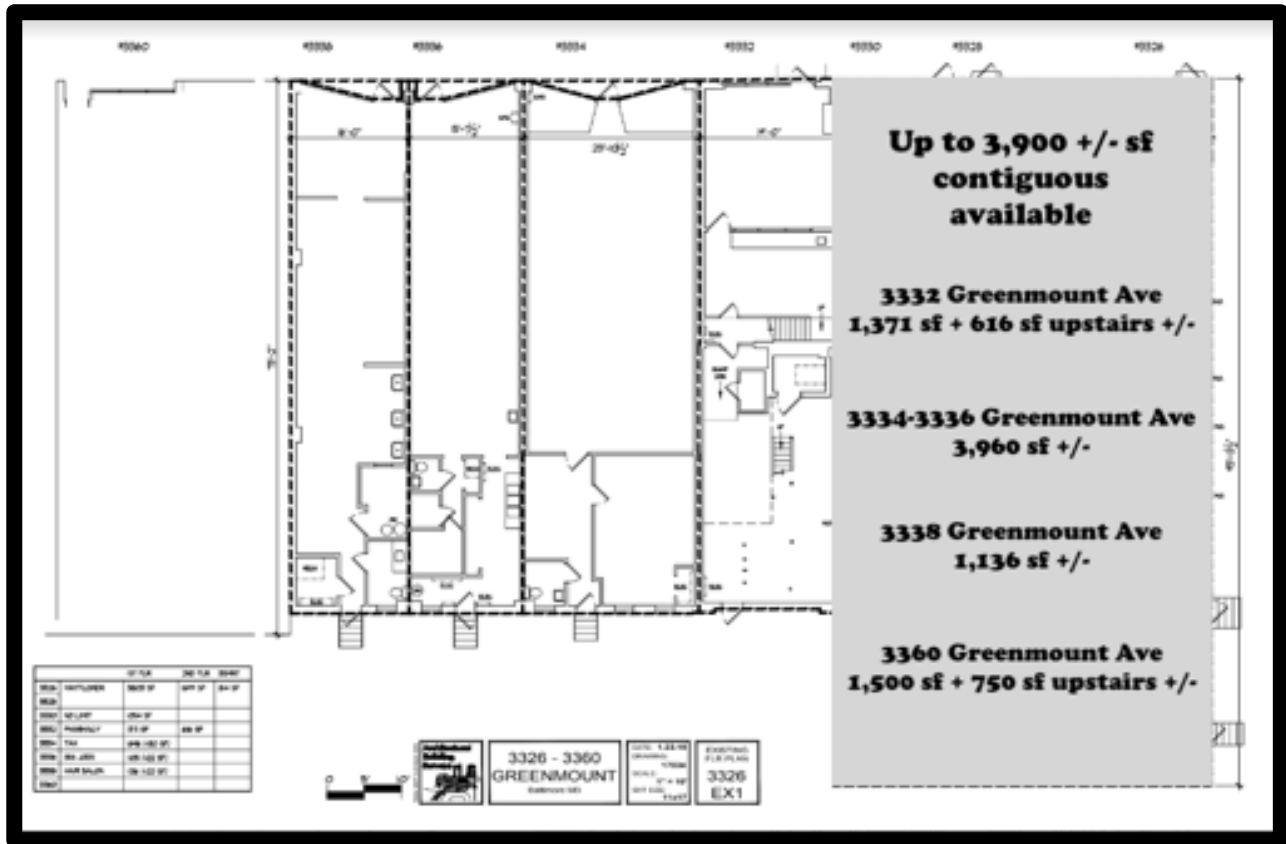

Alex Simone / Mitch Gold
Gold and Company, LLC
5601 Newbury St.
Baltimore, MD 21209

410.578.1300
www.goldcommercial.net



Gold and Company

Commercial Real Estate in the Baltimore Metropolitan Area

3332-3360 Greenmount Avenue, Baltimore, MD 21218

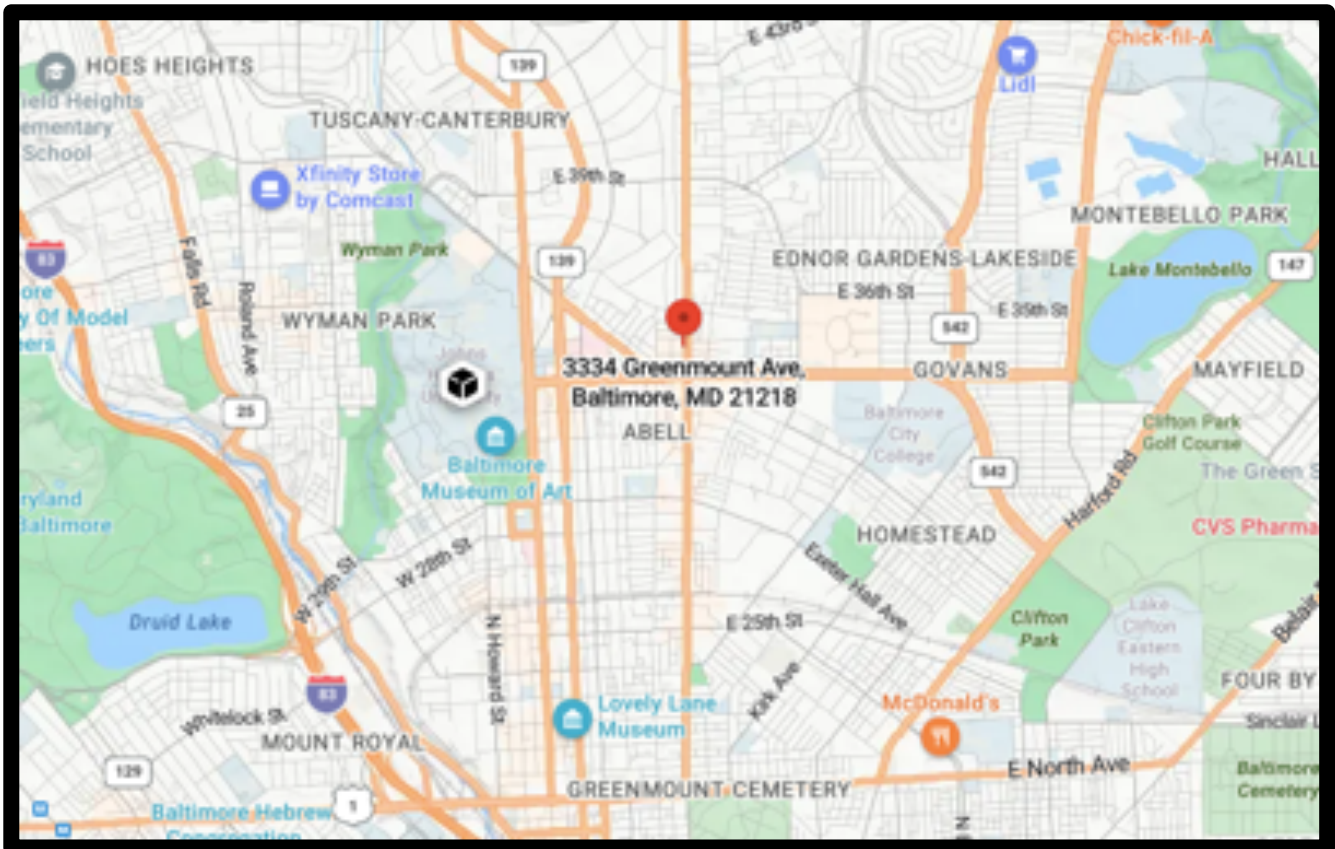

Alex Simone / Mitch Gold
Gold and Company, LLC
5601 Newbury St.
Baltimore, MD 21209

410.578.1300
www.goldcommercial.net