



# **GOLD AND COMPANY, LLC**



**7930 Solley Rd. Glen Burnie, MD 21060**

## **Gold And Company, LLC**

**5601 Newbury St.  
Baltimore, MD 21209**

**Jim Chivers  
jim@goldcommercial.net  
443.928.7522 Cell**

**Office: 410.578.1300  
www.goldcommercial.net**

- **Industrial Land Available FOR SALE**
- **8.687 Total Acres**
- **Two Parcels (Map 0010 and Parcels 0109, 0110)**
- **Anne Arundel County**
- **W-2 and W-1 Zoning**
- **Located in MD State Priority Funding Area**
- **Access to Public Water and Sewer**
- **Close Proximity to Fairfield Port / Curtis Bay**
- **Ideal for Contractor Serving Baltimore / DC**
- **Call For More Information**



# Gold And Company

*Commercial Real Estate in the Baltimore Metropolitan Area*

**7930 Solley Rd. Glen Burnie, MD 21060**

## Tax Map with Land Area Info

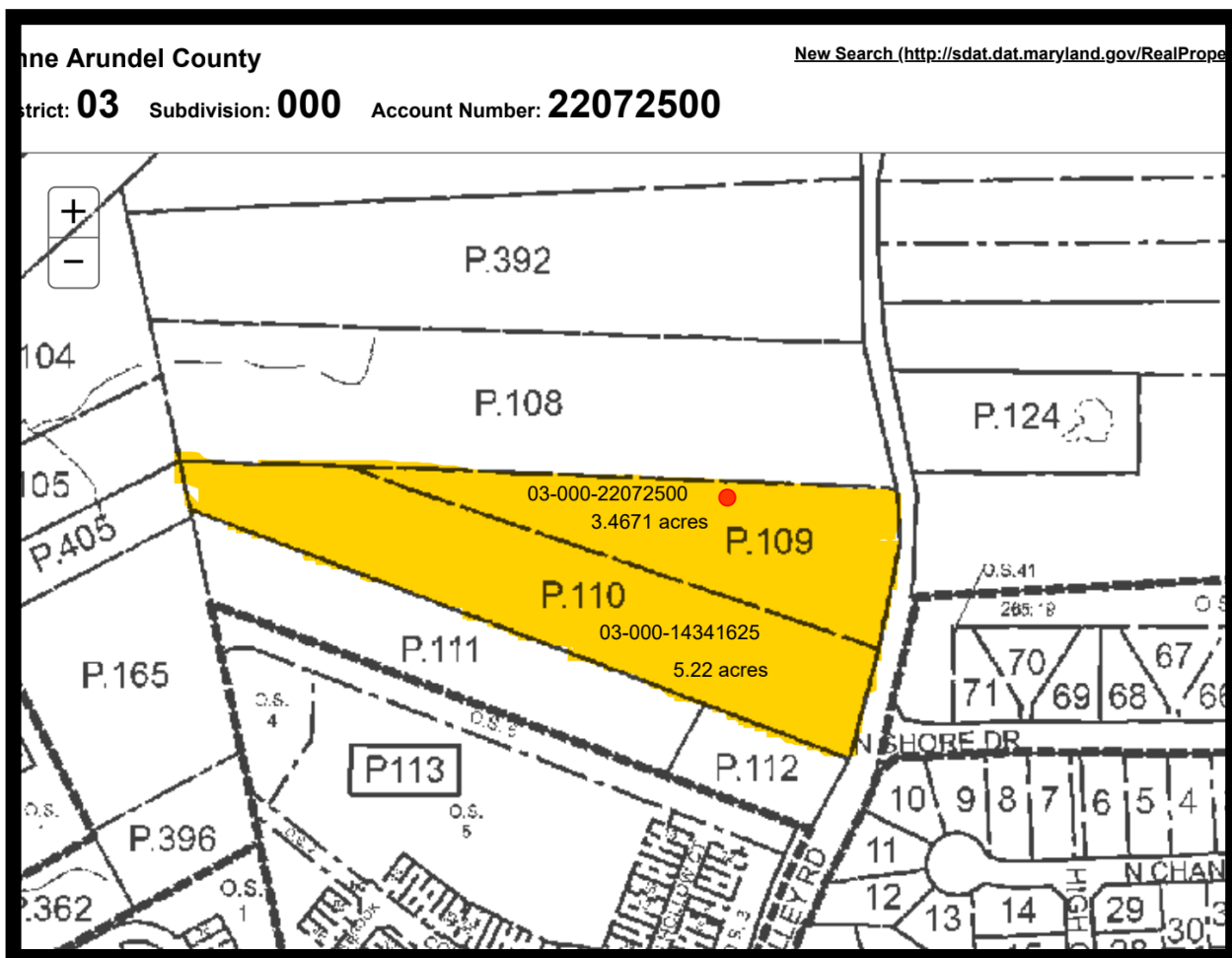

**Jim Chivers**  
**Gold And Company, LLC**  
**5601 Newbury St.**  
**Baltimore, MD 21209**

**[www.goldcommercial.net](http://www.goldcommercial.net)**  
**410.578.1300**

This property offering is subject to change without notice. All information is deemed reliable but not guaranteed.





This property offering is subject to change without notice. All information is deemed reliable but not guaranteed.





This property offering is subject to change without notice. All information is deemed reliable but not guaranteed.