

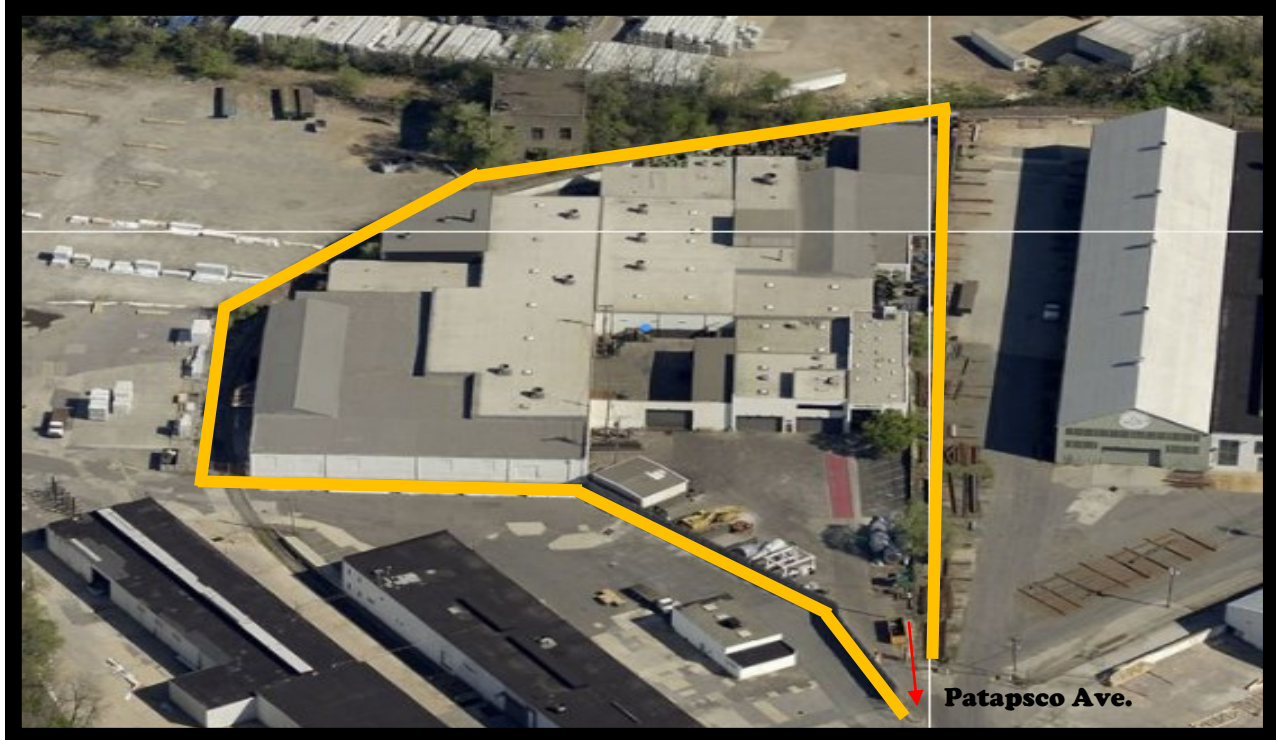

GOLD AND COMPANY, LLC



1026 E. Patapsco Ave. Baltimore, MD 21226

Gold And Company, LLC

**5601 Newbury St.
Baltimore, MD 21209**

**Jim Chivers / Mitch Gold
Gary Glover**

Office: 410.578.1300

Fax: 410.578.0200

www.goldcommercial.net

- **Functioning Metals Recycling Facility**
- **94,000 sf on 3.5 Acres**
- **Near Port of Baltimore**
- **Dock and Drive In Loading**
- **Zoned Heavy Industrial (M-3)**
- **Located in an Enterprise Zone**
- **Lease or Sale**
- **Call For More Information**



GOLD AND COMPANY, LLC

1026 E. Patapsco Ave. Baltimore, MD 21226

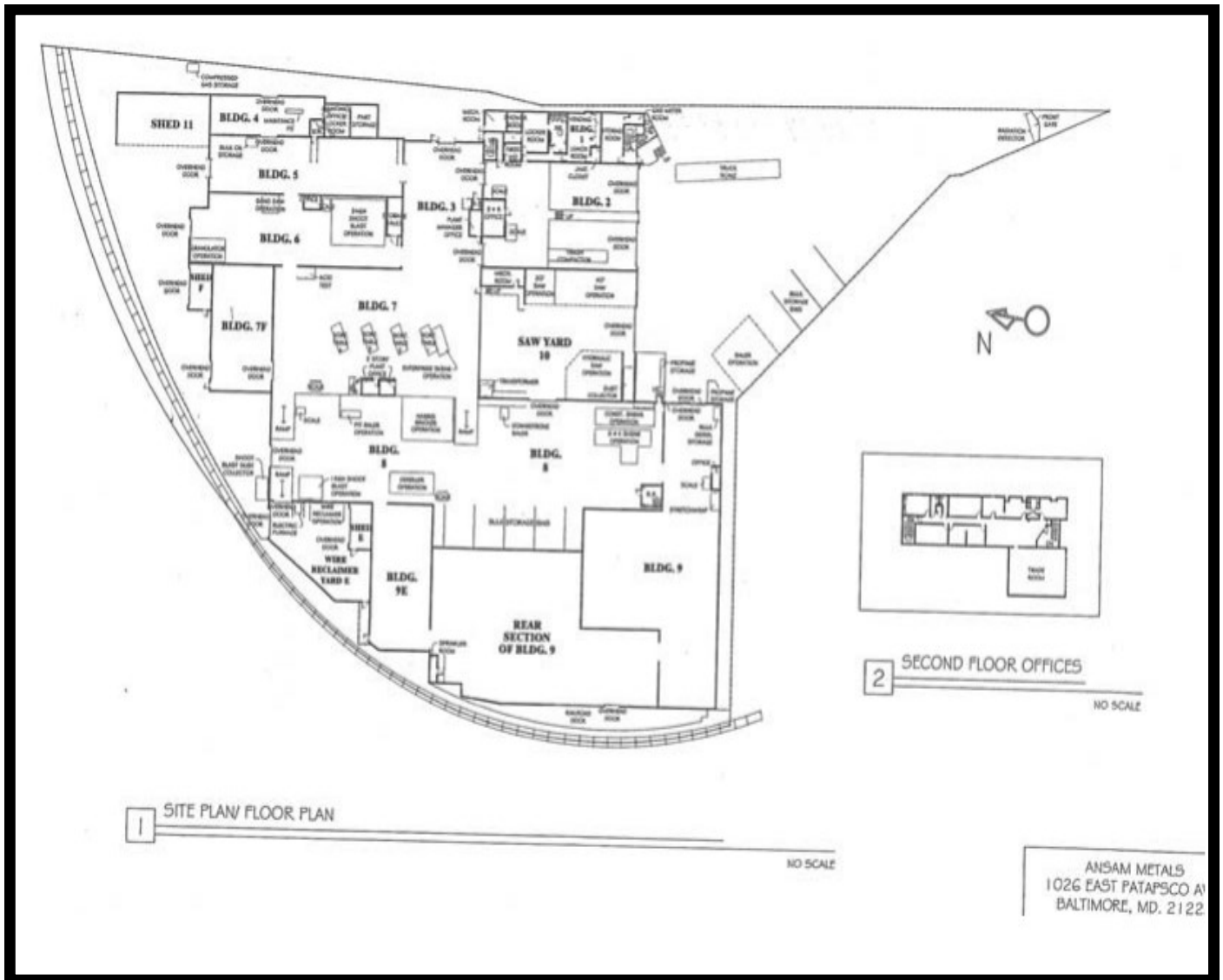

Jim Chivers / Mitch Gold / Gary Glover
Gold And Company, LLC
5601 Newbury St.

410.578.1300 (Office)
410.578.0200 (Fax)
www.goldcommercial.net



GOLD AND COMPANY, LLC

1026 E. Patapsco Ave. Baltimore, MD 21226

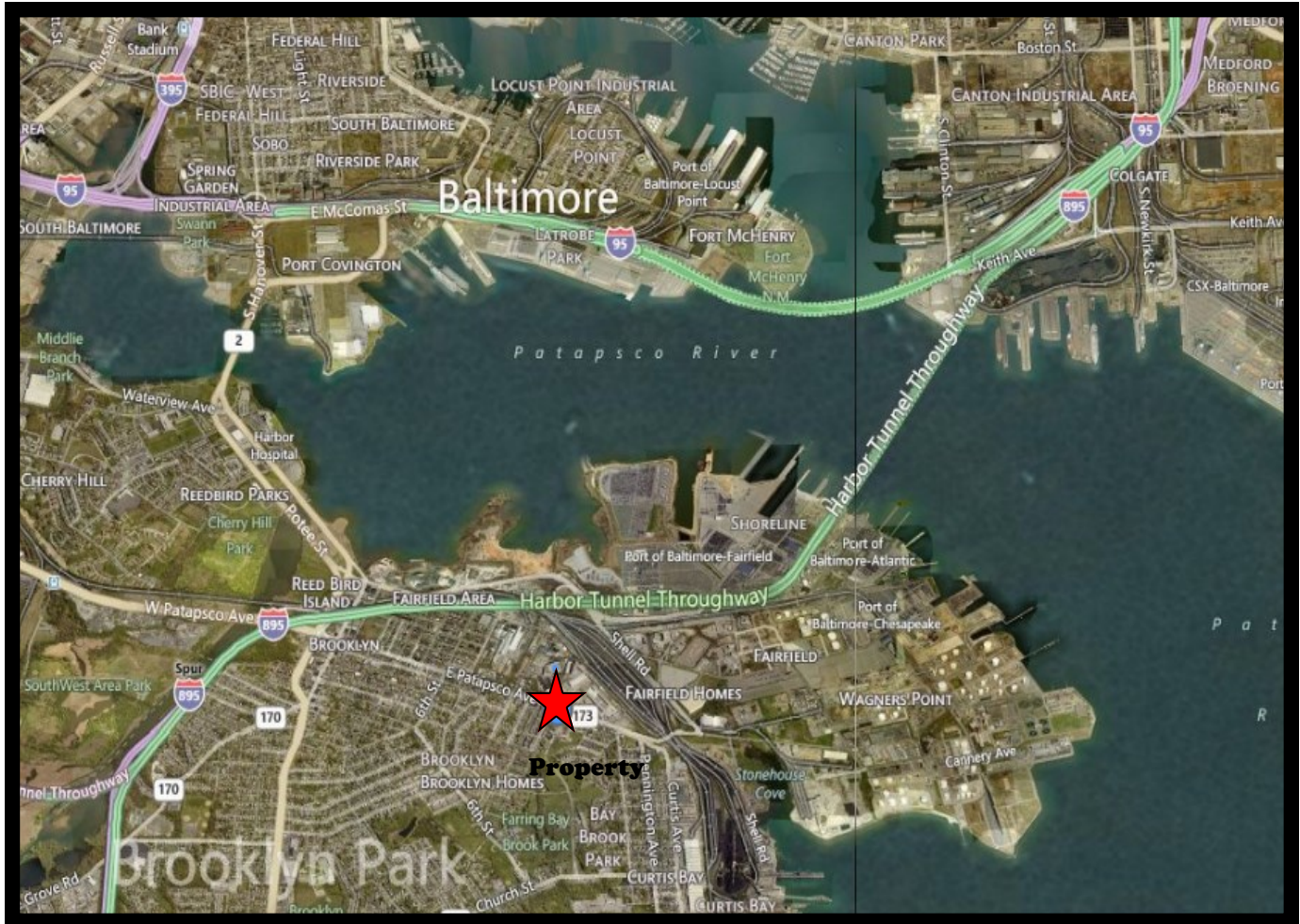

Jim Chivers / Mitch Gold / Gary Glover

Gold And Company, LLC

5601 Newbury St.

410.578.1300 (Office)

410.578.0200 (Fax)

www.goldcommercial.net