



# **GOLD AND COMPANY, LLC**

**6.9 Acres For Sale**  
**Baltimore Industrial Waterfront**  
**1999 Chesapeake Avenue**



## **Gold And Company, LLC**

**5601 Newbury St.  
Baltimore, MD 21209**

**Mitch Gold / Jim Chivers**  
**Office: 410.578.1300**  
**Fax: 410.578.0200**  
**[www.goldcommercial.net](http://www.goldcommercial.net)**

- **6.975 Acres Fast Land**
- **8.654 Acres Submerged Land**
- **Port of Baltimore—Fairfield Area**
- **M-3 Zoning (Heavy Industrial)**
- **Access to a Channel with 36' Water**
- **Existing +/- 400' Bulkhead**
- **Expand Bulkhead to +/- 800'**
- **Income Producing (Three Tenants)**
- **Call For More Information**



# GOLD AND COMPANY, LLC

1999 Chesapeake Ave., Baltimore, MD 21226

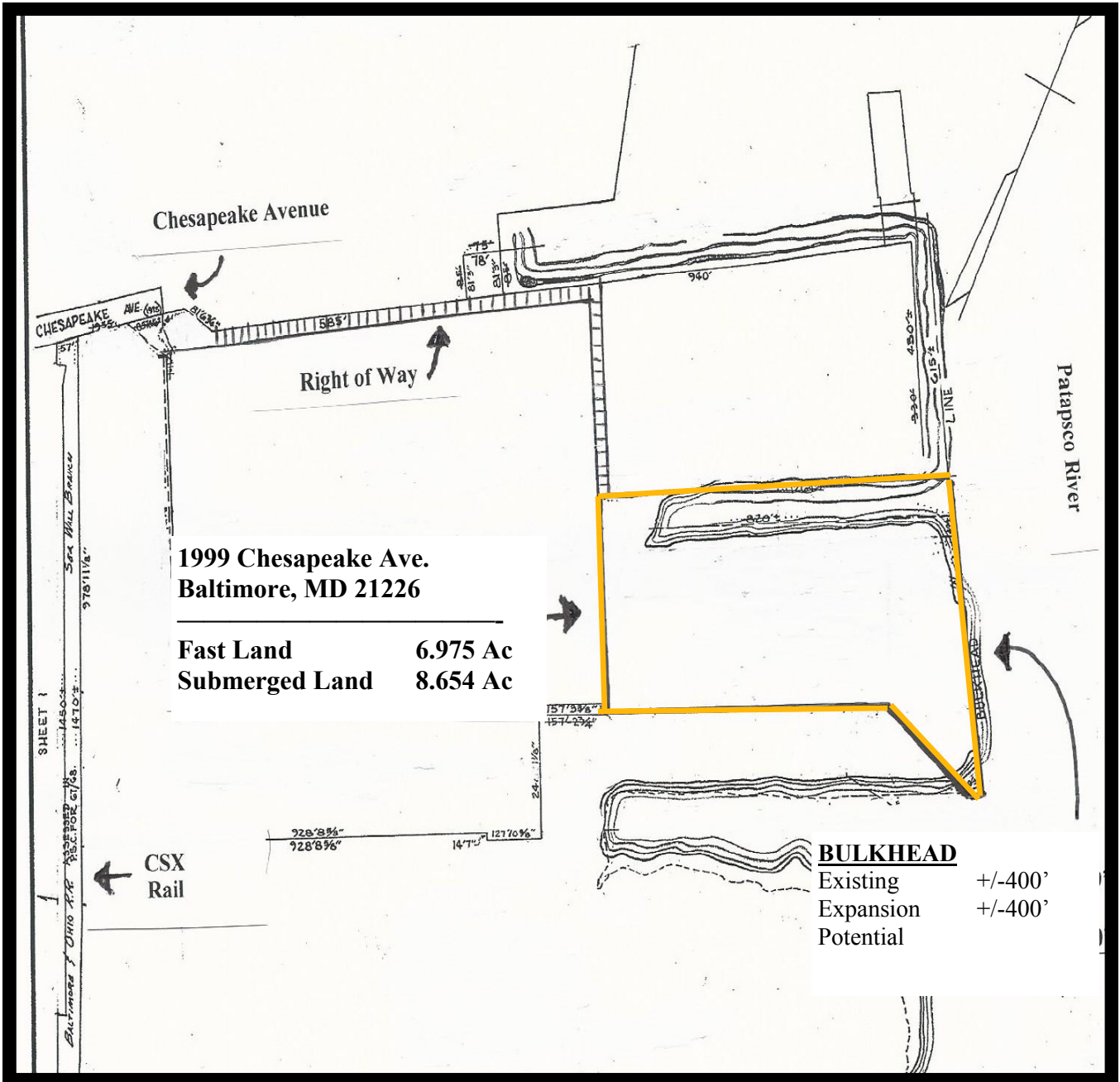

**Mitch Gold / Jim Chivers**  
**Gold And Company, LLC**  
**5601 Newbury St.**  
**Baltimore, MD 21209**

**410.578.1300 (Office)**  
**410.578.0200 (Fax)**  
**www.goldcommercial.net**



# Gold And Company

*Commercial Real Estate in the Baltimore Metropolitan Area*

**1999 Chesapeake Ave., Baltimore, MD 21226**

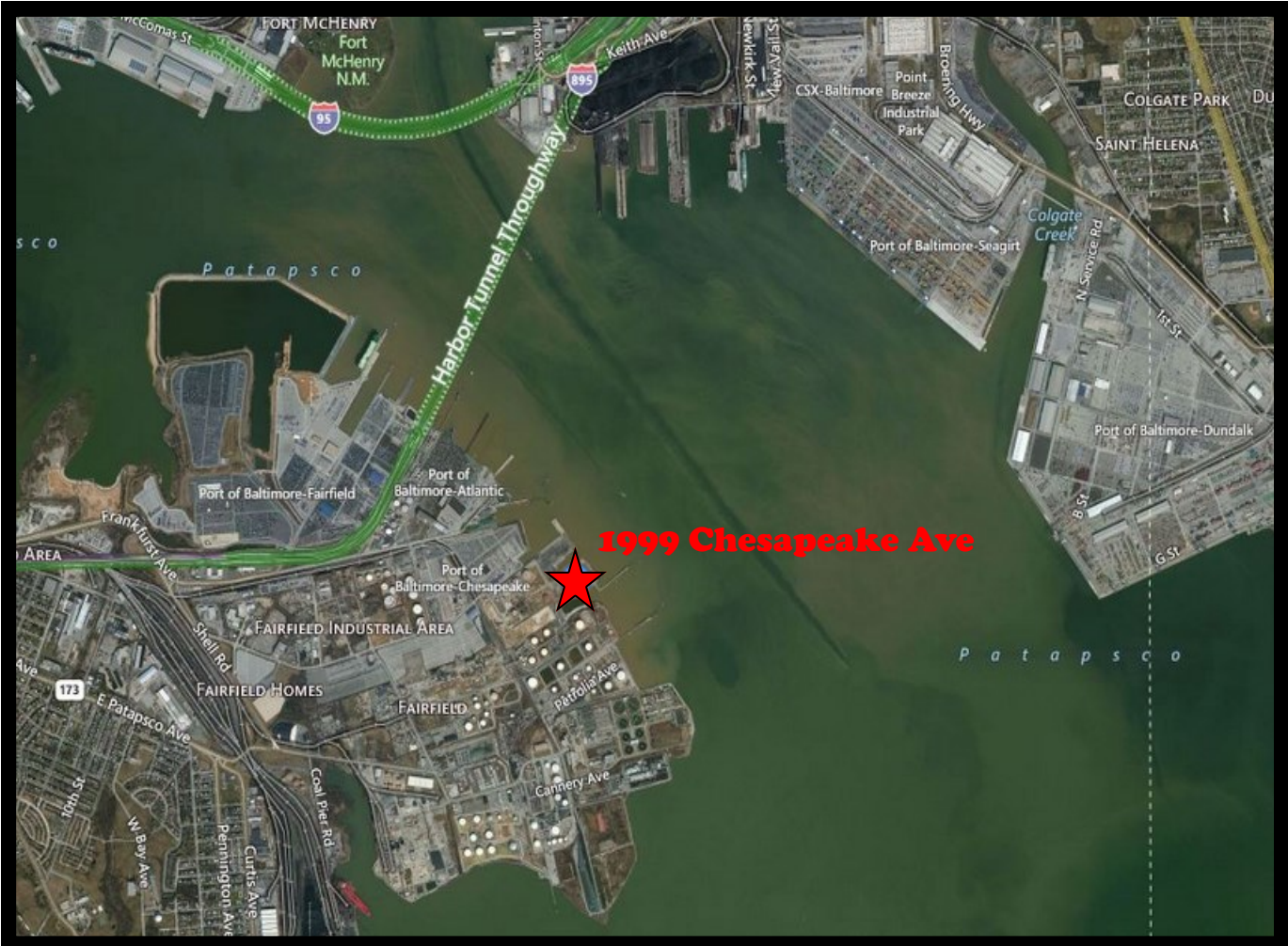

**Mitch Gold / Jim Chivers**  
**Gold And Company, LLC**  
**5601 Newbury St.**  
**Baltimore, MD 21209**

**410.578.1300 (Office)**  
**410.578.0200 (Fax)**  
**[www.goldcommercial.net](http://www.goldcommercial.net)**