

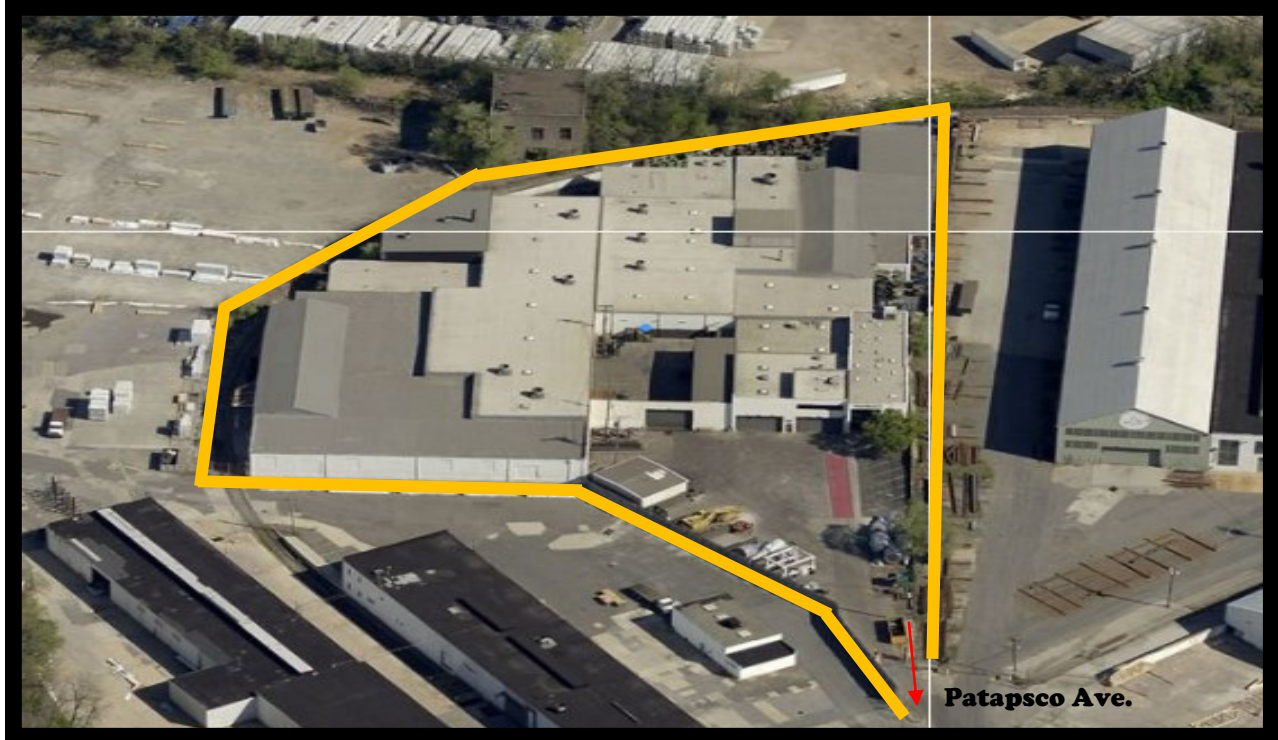

# **GOLD AND COMPANY, LLC**



**1026 E. Patapsco Ave. Baltimore, MD 21226**

## **Gold And Company, LLC**

**5601 Newbury St.  
Baltimore, MD 21209**

**Jim Chivers / Mitch Gold  
Gary Glover**

**Office: 410.578.1300**

**Fax: 410.578.0200**

**[www.goldcommercial.net](http://www.goldcommercial.net)**

- **Functioning Metals Recycling Facility**
- **94,000 sf on 3.5 Acres**
- **Near Port of Baltimore**
- **Dock and Drive In Loading**
- **Zoned Heavy Industrial (M-3)**
- **Lease or Sale**
- **Call For More Information**



# GOLD AND COMPANY, LLC

**1026 E. Patapsco Ave. Baltimore, MD 21226**

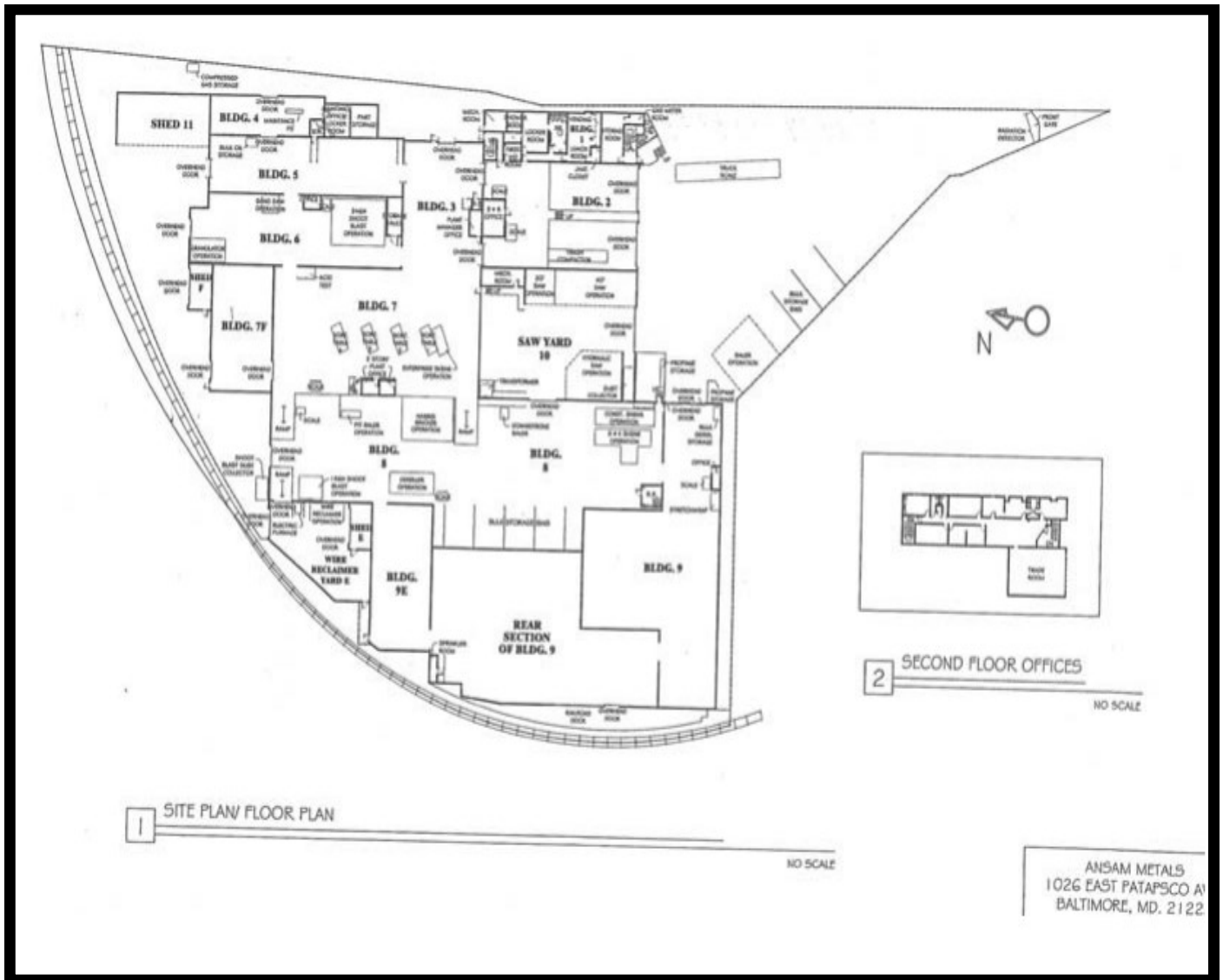

**Jim Chivers / Mitch Gold / Gary Glover**  
**Gold And Company, LLC**  
**5601 Newbury St.**

**410.578.1300 (Office)**  
**410.578.0200 (Fax)**  
**www.goldcommercial.net**



# GOLD AND COMPANY, LLC

**1026 E. Patapsco Ave. Baltimore, MD 21226**

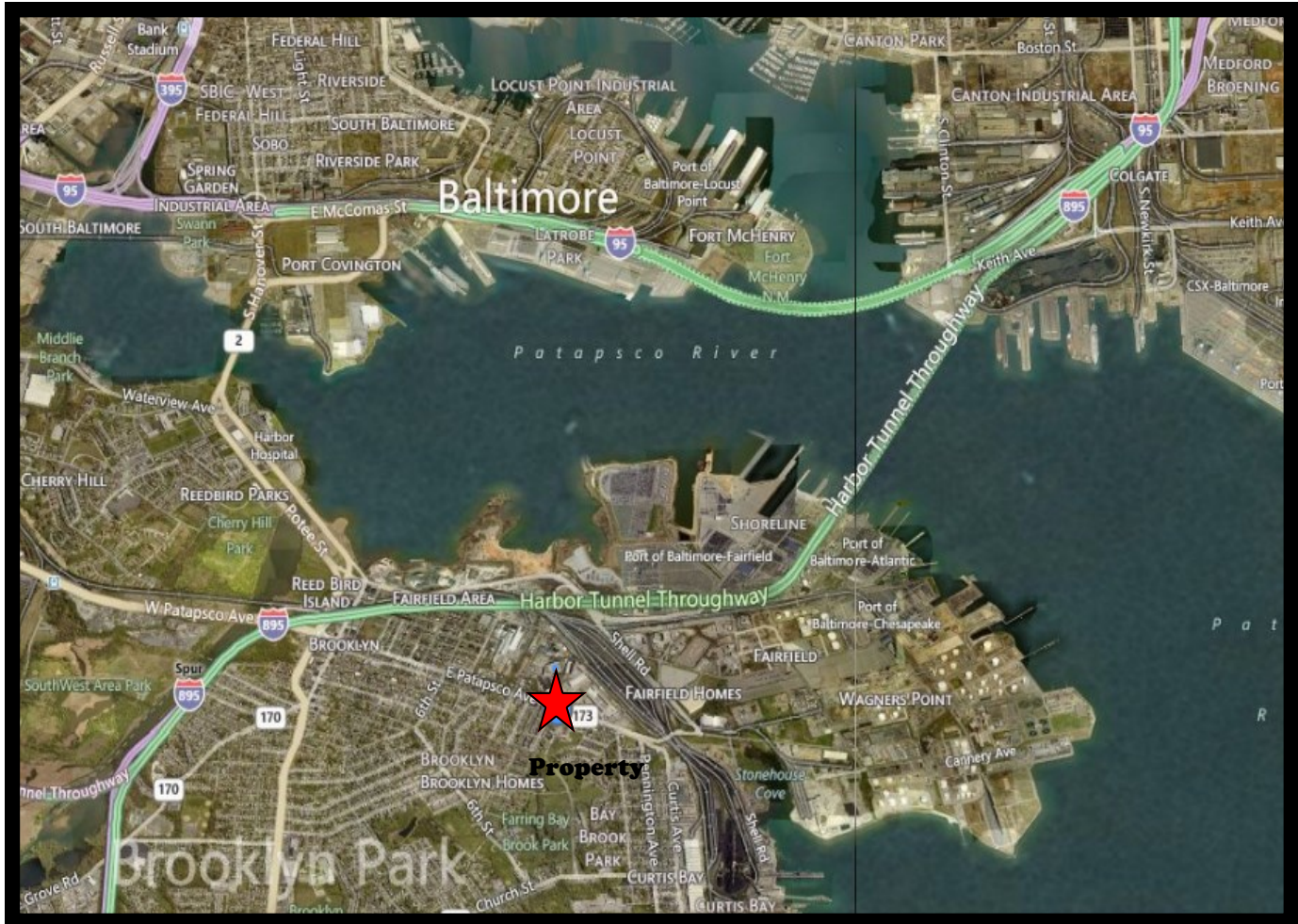

**Jim Chivers / Mitch Gold / Gary Glover**

**Gold And Company, LLC**

**5601 Newbury St.**

**410.578.1300 (Office)**

**410.578.0200 (Fax)**

**[www.goldcommercial.net](http://www.goldcommercial.net)**